

# INSTALLATION MANUAL

## 22010 IR Switch Motion Sensor

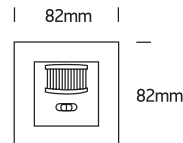

230V | 200W | IP20 | IR Switch motion sensor



Time delay: 10sec  $\pm$  3sec to 7min  $\pm$  2 min (adjustable)  
Ambient light:  $<3 \pm 2000$ lux (adjustable)  
Suggested installation height: 1-1,8m

one  
LIGHT

### INSTALLATION

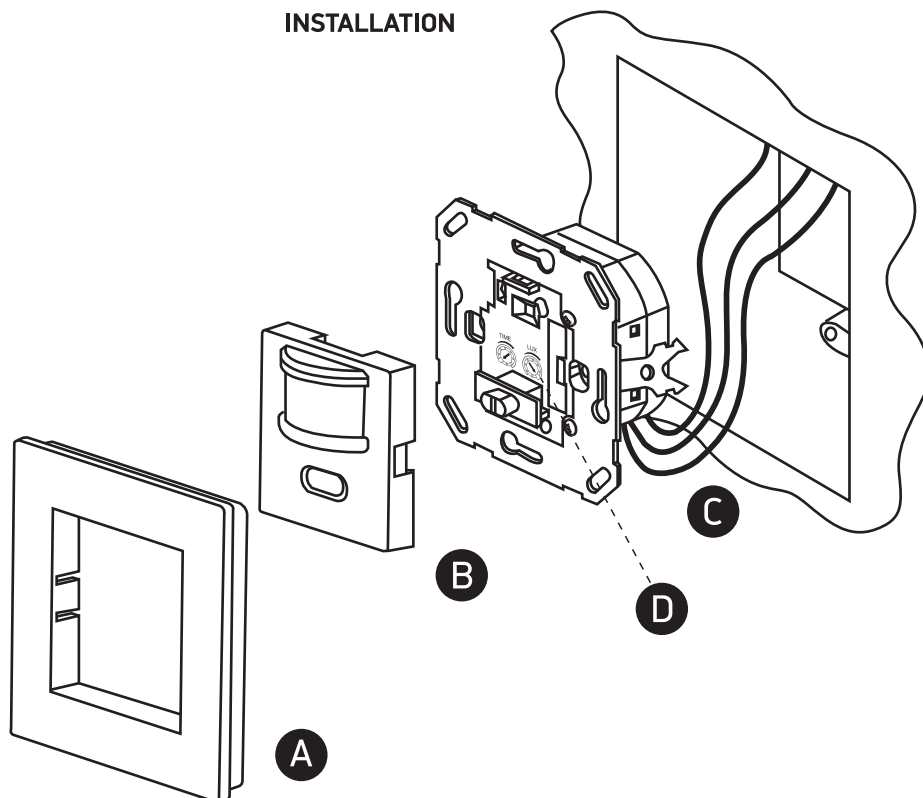

### WIRING DIAGRAM

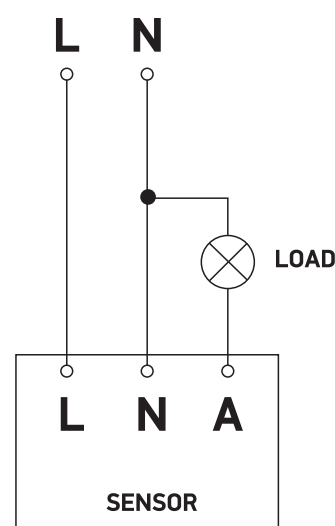

### TEST:

- Set the function switch to "ON", set "TIME" anti-clockwise to minimum, "LUX" clockwise to maximum.
- Switch on the power, the lamp should be on.
- Set the function switch to "OFF", the lamp should be off immediately.
- Set the function switch to "PIR", Switch on the power; the sensor and its connected lamp will have no signal at the beginning. After warm-up 30sec, the sensor can start work. If the sensor receives the induction signal, the lamp will turn on. While there is no another induction signal any more, the load should stop working within 10sec  $\pm$  3sec and the lamp would turn off.
- Set "LUX" anti-clockwise to minimum, if the ambient light is more than 3LUX, the inductor load should not work after the load stop working. If the ambient light is less than 3LUX (darkness), the sensor would work. Under no induction signal condition, the load should stop working within 10sec  $\pm$  3sec.

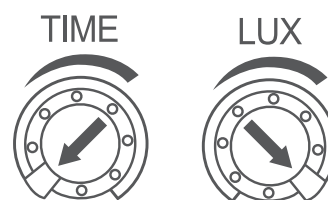

### Note:

Note: when testing in daylight, please turn LUX knob to ☀ position, otherwise the sensor lamp could not work. If the lamp is more than 60W, the distance between lamp and sensor should be 60cm at least.

### Warnings:

1. Make sure that the product is installed properly before connecting to electricity.
2. Do not cover the fitting.
3. Maintenance and installation should only be carried out by a professional electrician.